

Note :-

1. BUILDING HAS AUTOMATIC SPRINKLER SYSTEM WHEREVER REQUIRED BY NBC.
2. BUILDING WILL BE DESIGNED (STRUCTURES) AS PER RELEVANT IS CODES FOR EARTH QUAKE RESISTANCE.
3. BUILDING IS ARTIFICIALLY LIGHTED MECHANICALLY VENTILATED & CENTRALLY AIRCONDITIONED WITH 100% POWER BACKUP

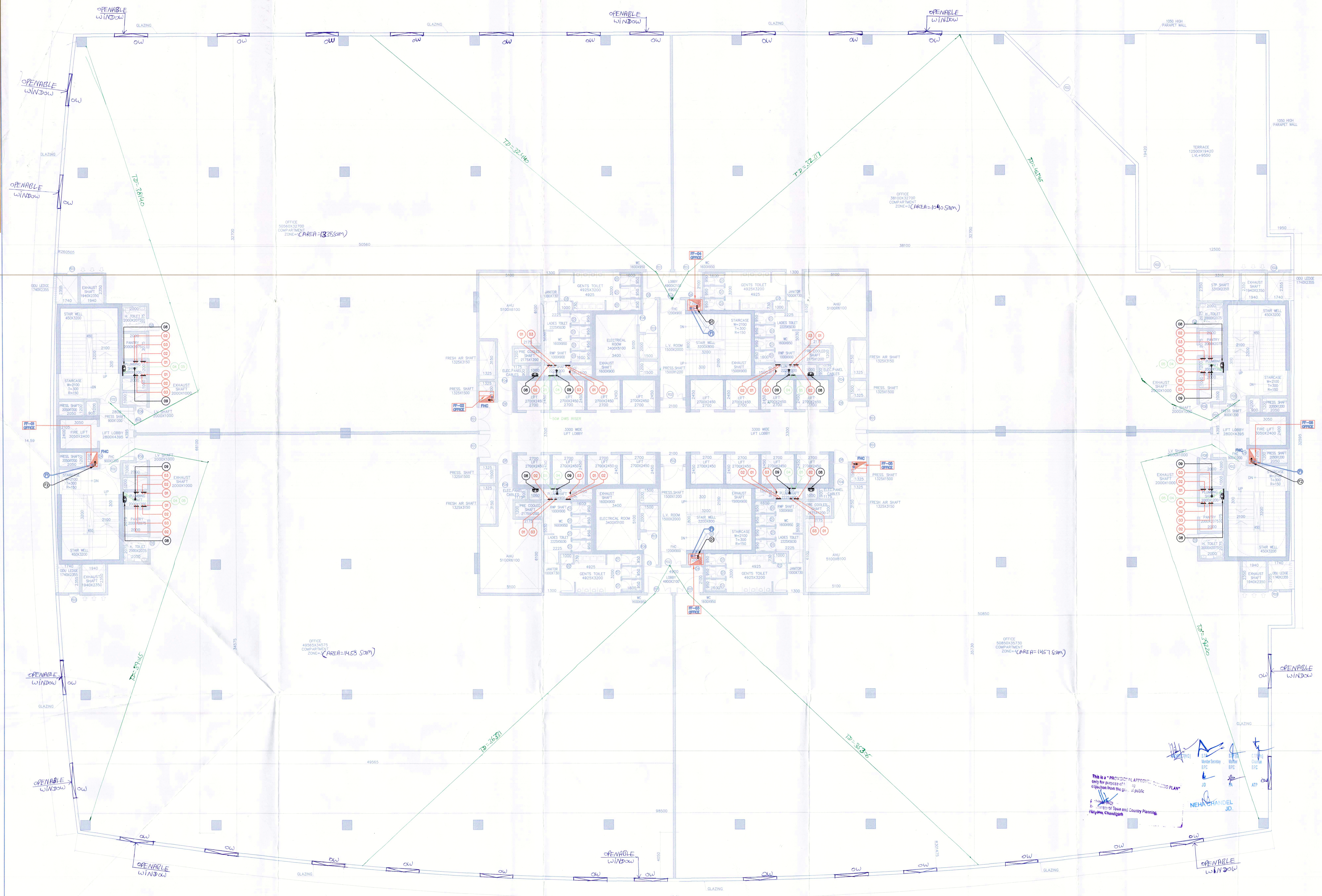

2ND FLOOR PLAN
LVL+9550
BUILDING=2

SR NO	PARTICULARS	SIZE	PER PARTIAL
D1	TOILET DOOR	750x2400	
D2	JANITOR	800x2400	
D3	PASSAGE	1000x2400	
D4	STAIR	900x2400	
D5	STAIR PASSAGE	1000x2400	
F01	OFFICE ENTRANCE	2000x2400	2 HR
F02	STAIRCASE/LIFT LOBBY	1700x2400	2 HR
F03	LIFT SHAFT	1000x2400	2 HR
F04	STAIRCASE	1200x2400	2 HR
F05	ELECTRICAL SHAFT	800x2400	2 HR
OW	OPENABLE WINDOW	1400x2400	

SR NO	PARTICULARS	SIZE	PER PARTIAL
1	100% SW. PRESS		
2	100% SW. PRESS		
3	100% SW. PRESS		
4	100% SW. PRESS		
5	100% SW. PRESS		
6	100% SW. PRESS		
7	100% SW. PRESS		
8	100% SW. PRESS		
9	100% SW. PRESS		
10	100% SW. PRESS		



RSMS ARCHITECTS PVT. LTD.
69, Nora Niwas Bhowani Kunj
(Behind D2), Vasant Kunj,
New Delhi-110070.
Tel.: 011-26898616, 26898617
www.rsms-arch.com

Project:
PROPOSED SUBMISSION OF UNDER TRANSIT ORIENTED DEVELOPMENT (TOD) POLICY FOR COMMERCIAL SITE MEASURING 32.36 ACRES FALLING IN RESIDENTIAL PLOTTED COLONY NAMED DLF CITY, PHASE-I, II & III IN SECTOR-24, 25 & 25A GURUGRAM-MANESAR URBAN COMPLEX BEING DEVELOPED BY DLF LIMITED.

OWNER: DLF CITY CENTRE LTD.
(THE SHOPPING MALL COMPLEX, ARUN MARG, DLF CITY, PHASE-I, GURGAON - 122002, HARYANA.)

DRAWING TITLE:-
Commercial and Residential Building-02

Checked and Approved for Public Health and Safety: [Signature] Deputy Director (T) Member B.P.C.

REVISION	JOB NO. :-	DRG NO. :-	NORTH :-
		B2-04	N
	SCALE :-	DATE :-	
	1:100	22-08-2019	

FILE - DEALT BY - CHECKED BY - APPROVED BY -

ARCHITECT'S SEAL & SIGNATURE: [Signature]
OWNER'S SEAL & SIGNATURE: [Signature]

